

RECESSED OUTDOOR BOTTLE FILLER WITH BI-LEVEL DRINKING FOUNTAIN

STANDARD FEATURES

- 115v Plug-in transformer
- Pushbutton and hands free sensor operated bottle filler
- 100 mesh inlet strainer
- Laminar flow water supply
- 1.0 GPM fill rate
- Lead-free
- Lead and cyst filter for bottle filler
- Bottle filler meets ADA forward and side reach requirements
- Vandal-resistant design
- Gasketed door for weather resistance
- ADA Complaint (when properly installed)
- Resistant to sunlight, heat, moisture and wear
- 18 gage, 304 stainless steel bowl
- 12 gage, heavy duty stainless steel arm, corrosion and scratch resistant
- Polished Stainless steel, anti-rotation non-squirt bubbler

SUGGESTED SPECIFICATIONS

Model is a recessed outdoor bottle filler. Housing has a slim and trim look that blends into your environment. Unit also has a strong vandal-resistant design for years of trouble-free service. Bottle filler shall be activated by a 9 volt sensor or a pushbutton as standard. Fixture has a self-closing pushbutton, needing less than 5 pounds of force which shall activate the internally mounted valve. When installed properly, the bottle filler complies with ADA forward and side reach requirements. Bottle filler is fabricated of type 304 stainless steel. Unit includes GRD series bi-level barrier free drinking fountains. Bottle filler cabinets and drinking fountains shall be either stainless steel with powder coat or satin finish. Unit complies with ANSI A117.1, Public Law 111-380 (NO-LEAD), CHSC 116875 and NSF/ANSI 61, Section 9. Fixture meets ADA, ADA Standing Person and ADA Child requirements when mounted appropriately.



MODEL:

(Must Specify)

- Satin stainless finish (Shown)
- Green powder-coated
- Red powder-coated
- Blue powder-coated *Custom color finishes available upon request*

OPTIONS

(additional costs may be incurred)

- BAT Battery operated (N/A with bottle counter)
- BCD Bottle counter display
- FRA3 Freeze resistant valve system, 3 valves (Less filter and sensor)
- LOGO Customer specified logo
- MO Bottle filler operated by pushbutton only (Standard with freeze-resistant valves)
- RBL Reverse Bi-Level (Bottle Filler Opposite) (Roughs-ins are opposite of shown)
- SK7 Cane Skirt
- A9100080-A 8 GPH remote water chiller (Locate on interior wall, not exposed to weather)

Complies with the following standards:



Member of
U.S. Green
Building
Council



Recyclable
Product



Water
Conserving
Product

WARNING: Cancer and Reproductive Harm - www.P65Warnings.ca.gov

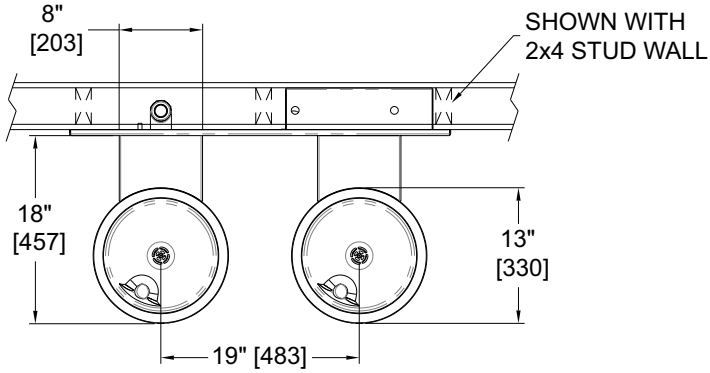

RECESSED OUTDOOR BOTTLE FILLER WITH BI-LEVEL DRINKING FOUNTAIN

GENERAL NOTES:

1. ALL DIMENSIONS ARE IN INCHES [MM]
- *2. DIMENSIONS SHOWN ARE FOR RECOMMENDED ADULT HEIGHT. ADJUST VERTICAL DIMENSIONS AS NECESSARY TO COMPLY WITH FEDERAL, STATE & LOCAL CODES
3. STOP VALVE NOT PROVIDED

