



Nurturing Creativity Through Innovative Play™

217 Murphy Ave • Ferguson, Kentucky 42533

Phone: 606-485-4406 • Fax: 606-485-4407

Email: info@goplaytopia.com • Web: www.goplaytopia.com

Recommended Crew:

Minimum 1-2 People

Tools Required for Assembly:

T-30 TORX Bit

3/8" Socket or Adjustable Wrench

Square Drive Bit

3/16" x 6" Drill Bit

Tape Measure

Level

High Speed 3/8" electric drill w/ clutch

Installation Time:

1 hour

This space intentionally left blank.

Standard Hardware

5/16" x 5"
RSS Stainless

5/16" x 4"
RSS Stainless

5/16" x 3-1/8"
RSS Stainless

5/16" x 2-1/2"
RSS Stainless

1/4" x 2-1/2"
RSS Stainless

#10 x 2-1/2"
R4 Stainless

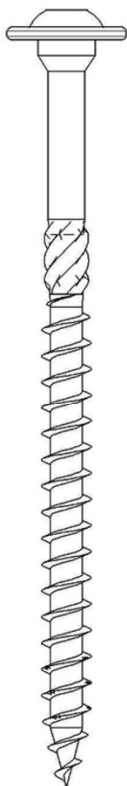
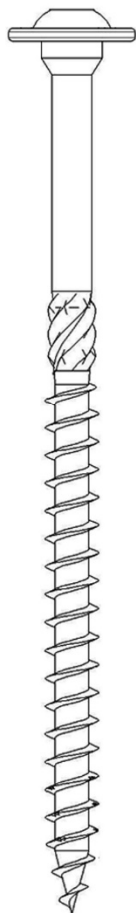
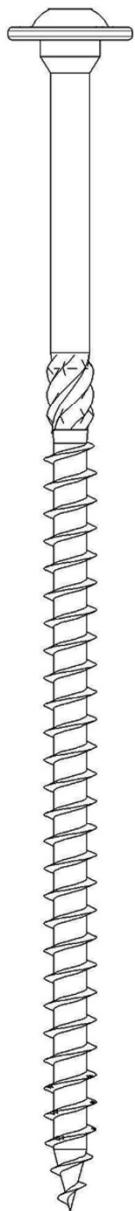

NOT TO SCALE!

Pre-Installation Check

Check off all items received, against the packing list. Notify your local sales representative immediately of any items that are missing or that may be damaged.

PLAYTOPIA, INC. IS NOT RESPONSIBLE
FOR ITEMS DISCOVERED MISSING
AFTER 72 HOURS FROM TIME OF
DELIVERY.

**PRE-DRILLING IS REQUIRED. ALL LOCATIONS WHERE
HARDWARE IS TO BE FASTENED REQUIRES PRE-
DRILLING TO ENSURE PROPER INSTALLATION AND
STRUCTURAL INTEGRITY. WE ARE NOT RESPONSIBLE
FOR INSTALLATION OR STRUCTURAL ISSUES THAT
ARISE FROM NOT PRE-DRILLING ATTACHMENTS.**

This space intentionally left blank.

Top Deck Frame Assembly

Locate the two main halves of the dog bone pool deck. Place on a flat surface and proceed to flush up the tops and sides of the frames.

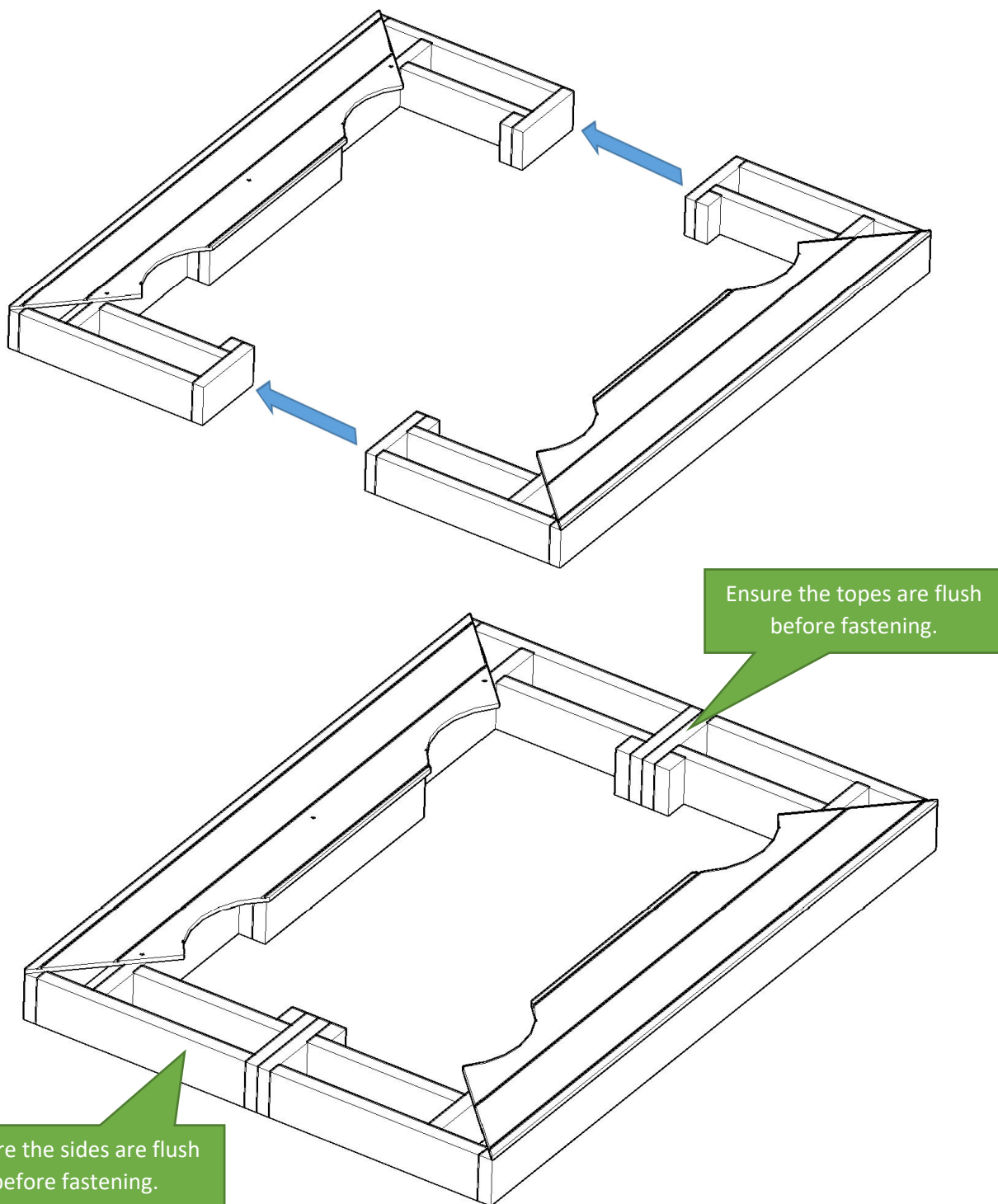

Top Deck Frame Assembly

Once the frames are in place, proceed to fasten (2) 3/8" x 2-3/4" Button Head Bolts with 3/8" Lock Nut and 3/8" Washers at each of the locations marked below. A total of (4) bolts will be used to connect the frames to each other.

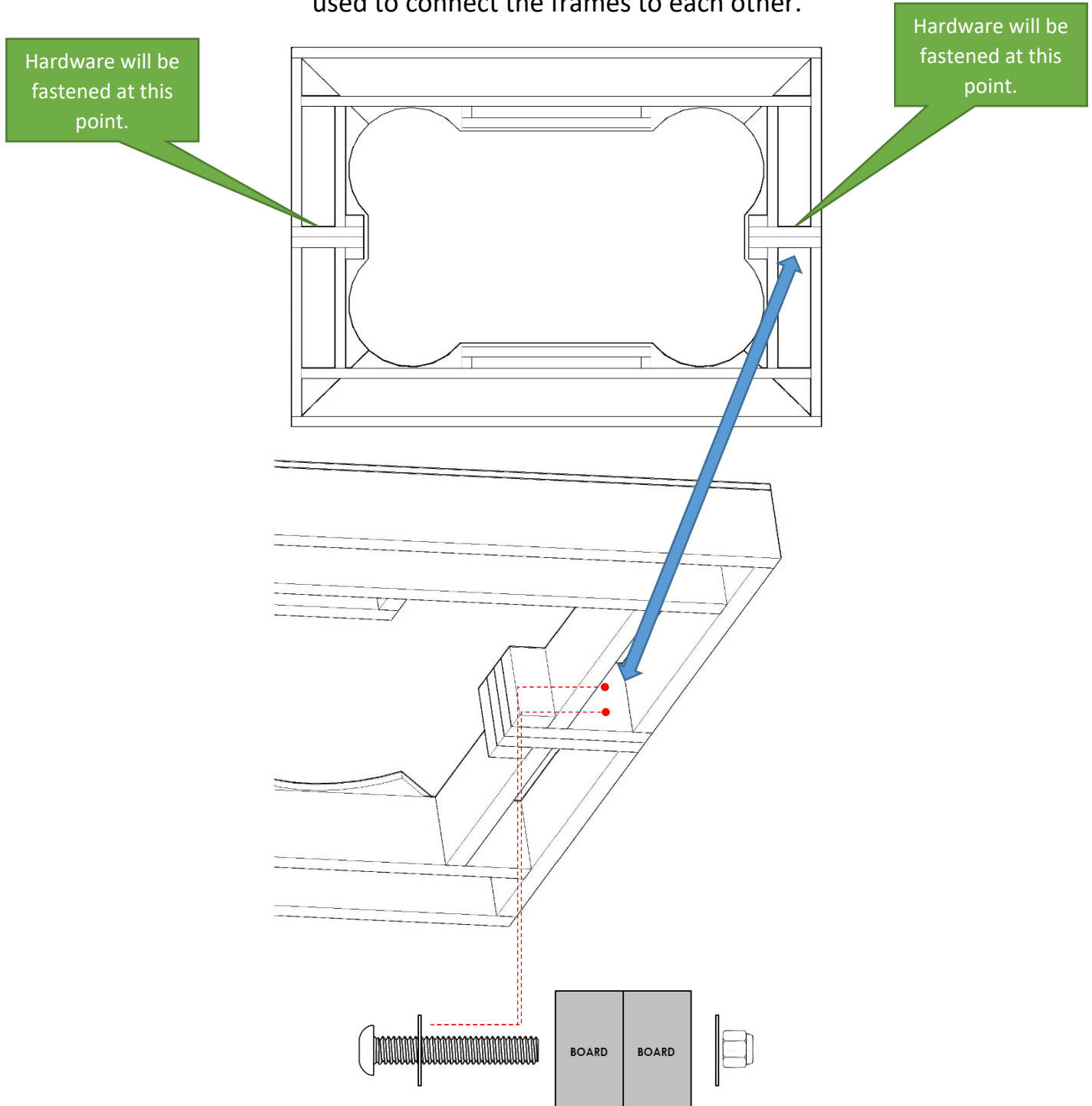

Main Frame Assembly

With the frames in place and assembled, proceed to fasten the remaining deck panels in place using (6) #10 x 2-1/2" Stainless Screws at the pre-marked locations shown below. Repeat for the remaining panel.

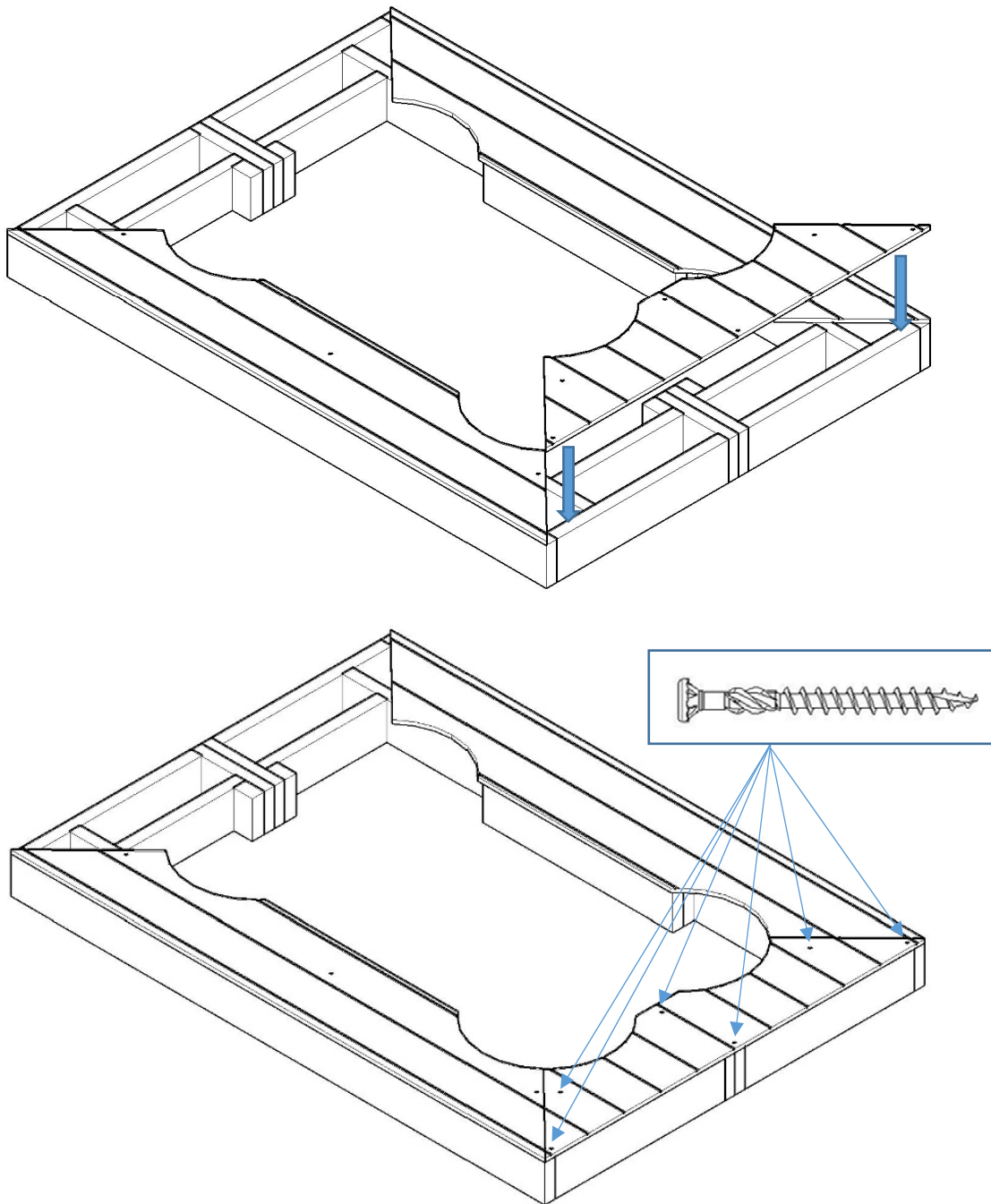

Final Assembly

With the top deck fully assembled, proceed to place Steps in place by centering them as shown below and letting the top deck rest on the ledges of the steps. No hardware is required for this step. The weight of the top deck will secure the steps in place.

