

# Plaza Handicap Picnic Table

For Fastener Pack  
(FP-PZTHA-CU-01)

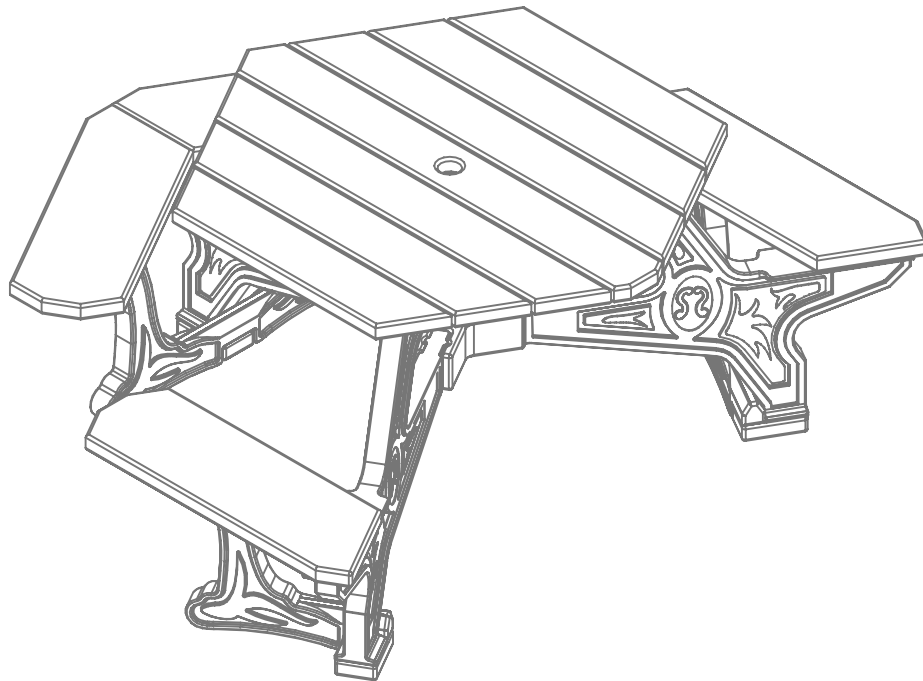

Congratulations ! !

You have just purchased the finest recycled plastic  
picnic table available. Enjoy ! ! !

Before assembly, please make sure all components are included.

**J - Table Top**

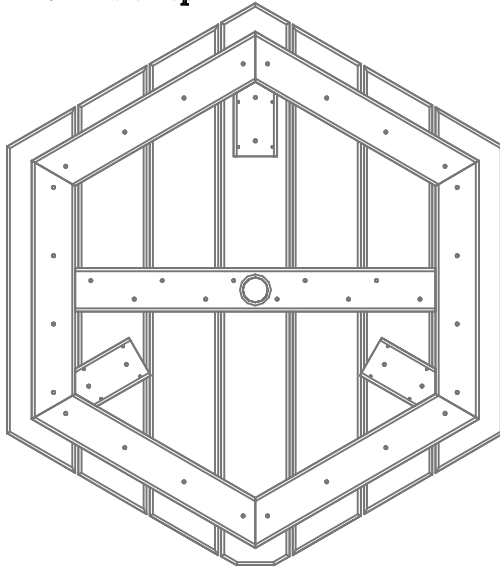

**( 1 ) - One Table Top**  
**GSSA-PZHA-A-01**



**( 1 ) - One Fastener Pack**  
**FP-PZTHA-CU-01**

**FP - Fastener Pack**



**( 1 ) - One Left Long Seat**  
**GSP-PZHA-A-01**

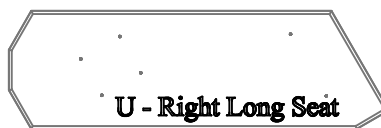

**( 1 ) - One Right Long Seat**  
**GSP-PZHA-B-01**

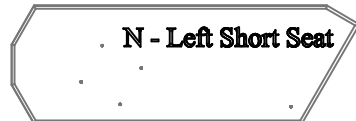

**( 1 ) - One Left Short Seat**  
**GSP-PZ-A-01**

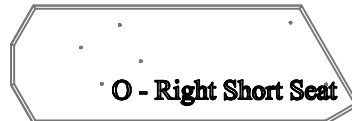

**( 1 ) - One Right Short Seat**  
**GSP-PZ-B-01**

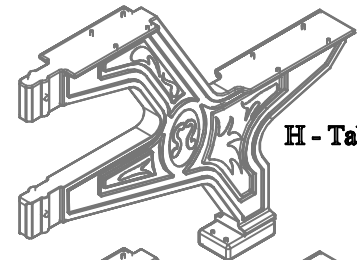

**H - Table Leg**

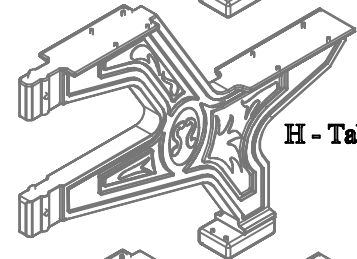

**H - Table Leg**

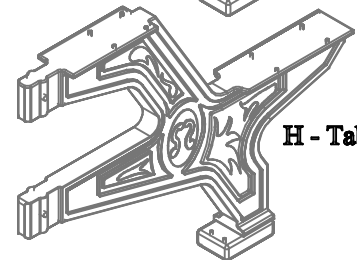

**H - Table Leg**

**( 3 ) - Three Table Legs**  
**GSSA-PZ-B-01**

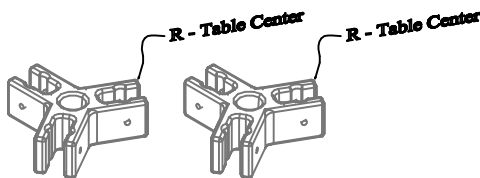

**( 2 ) - Two Table Centers**  
**PS-GSCP-A-01**

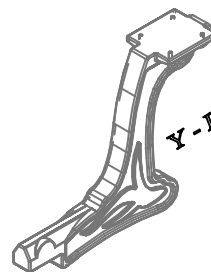

**( 1 ) - One Right HA Seat Support**  
**PS-GSSS-B-01**



**( 1 ) - One Left HA Seat Support**  
**PS-GSSS-C-01**

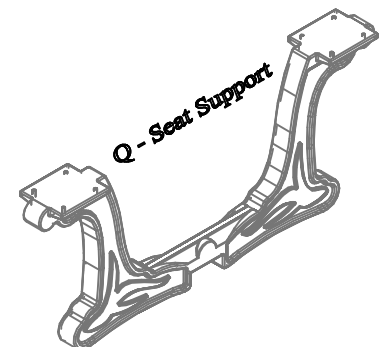

**( 1 ) - One Seat Support**  
**PS-GSSS-A-01**

Before assembly, please make sure all fasteners are included.

6 - 3/8" x 4 1/4" Hex Head Bolt

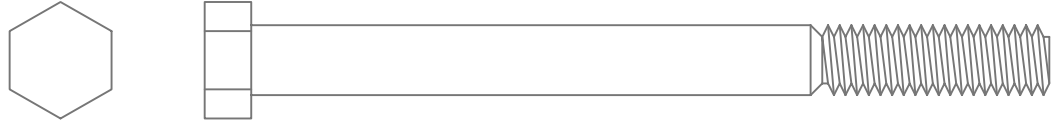

12 - 3/8" Flat Washer

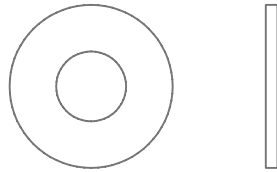

6 - 3/8" Nylon Lock Nut

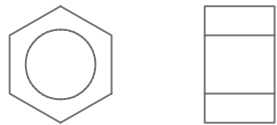

6 - #12 x 3" Flat Head Phillips Screw



36 - #12 x 1 1/2" Pan Head Phillips Screw

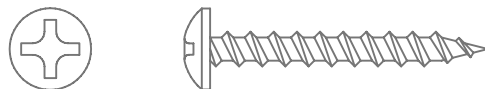

Also needed for this assembly will be the following materials:

1 - #3 Phillips Drive Bit

2 - 9/16" Socket Wrench

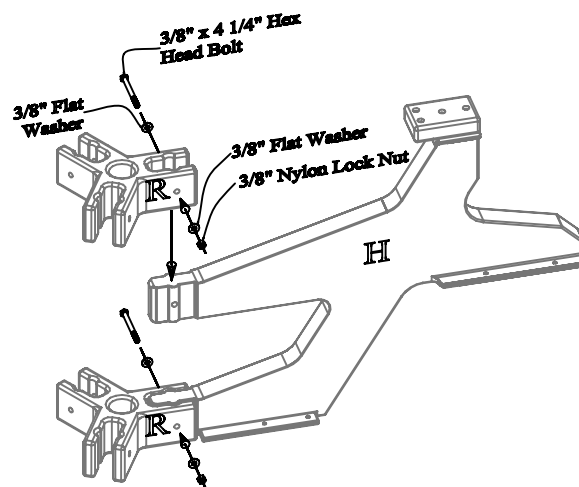

### Step #1:

Slide ( 1 ) One Table Center on to each end of the Table Leg as shown above. Use ( 1 ) One 3/8" x 4 1/4" Hex Head Bolt and ( 1 ) One 3/8" Flat Washer along with ( 1 ) One 3/8" Flat Washer and ( 1 ) One 3/8" Nylon Lock Nut per hole to secure.

Do not tighten bolts completely. This will be done in a later step.

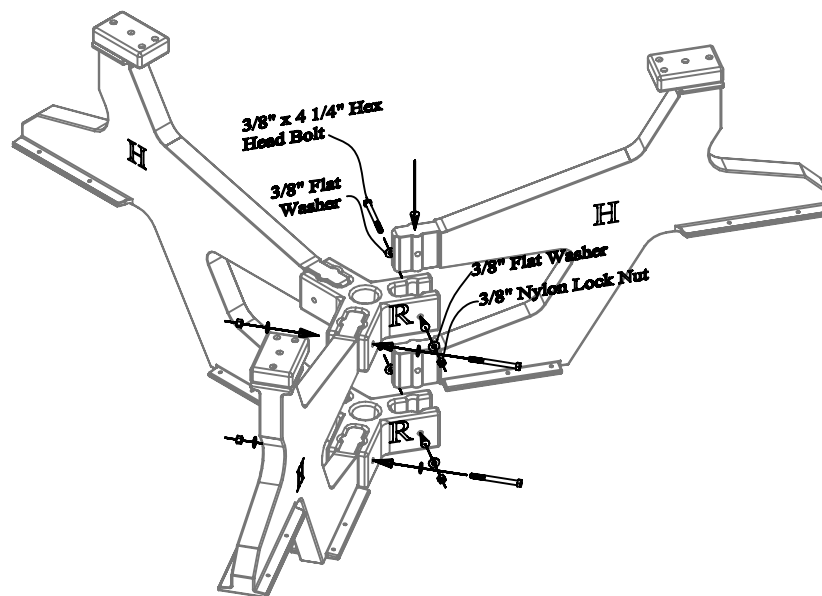

### Step #2:

Slide the remaining Table Legs in to the Table Centers. Use ( 1 ) One 3/8" x 4 1/4" Hex Head Bolt and ( 1 ) One 3/8" Flat Washer along with ( 1 ) One 3/8" Flat Washer and ( 1 ) One 3/8" Nylon Lock Nut per hole to secure.

Do not tighten bolts completely. This will be done in a later step.

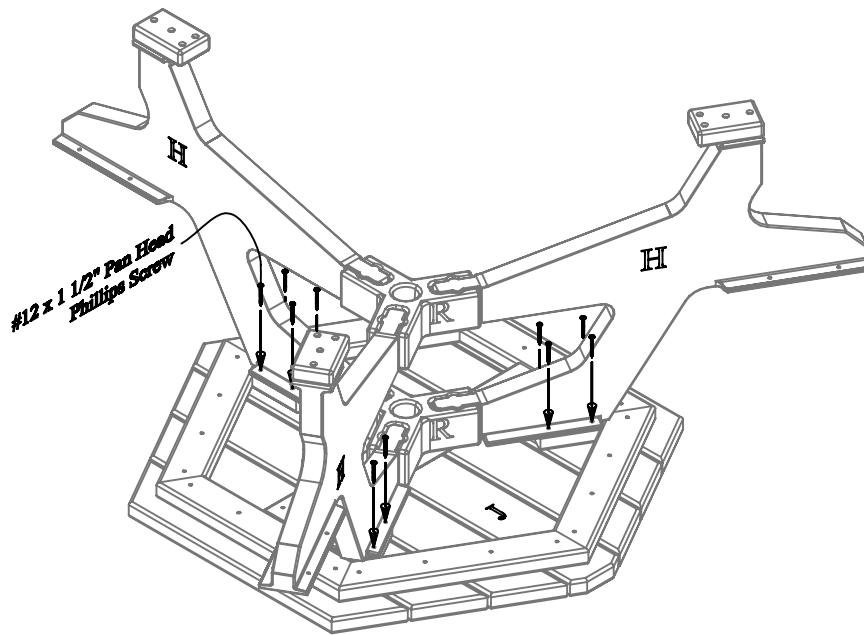

### Step #3:

While the Table Top is upside down, place the leg assembly onto the Table Top as shown above. Align the pre-drilled holes in the Table Legs with the pilot holes in the Table Top. Use ( 1 ) One #12 x 1 1/2" Pan Head Screw per hole to secure.

Be sure to tighten all screws after completing this step.

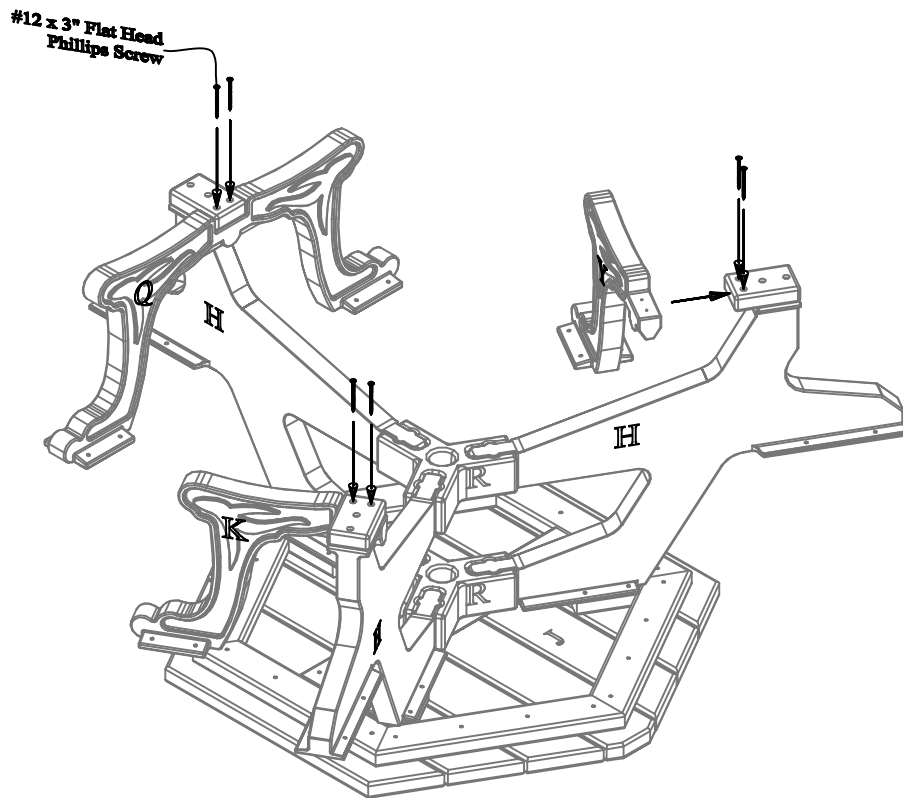

#### Step #4:

While the table is upside down, align the pre-drilled holes in the Table Leg to the pilot holes in the Seat Support as shown above. Use ( 1 ) One #12 x 3" Flat Head Screw per hole to secure.

Do not tighten screws completely. This will be done in a later step.

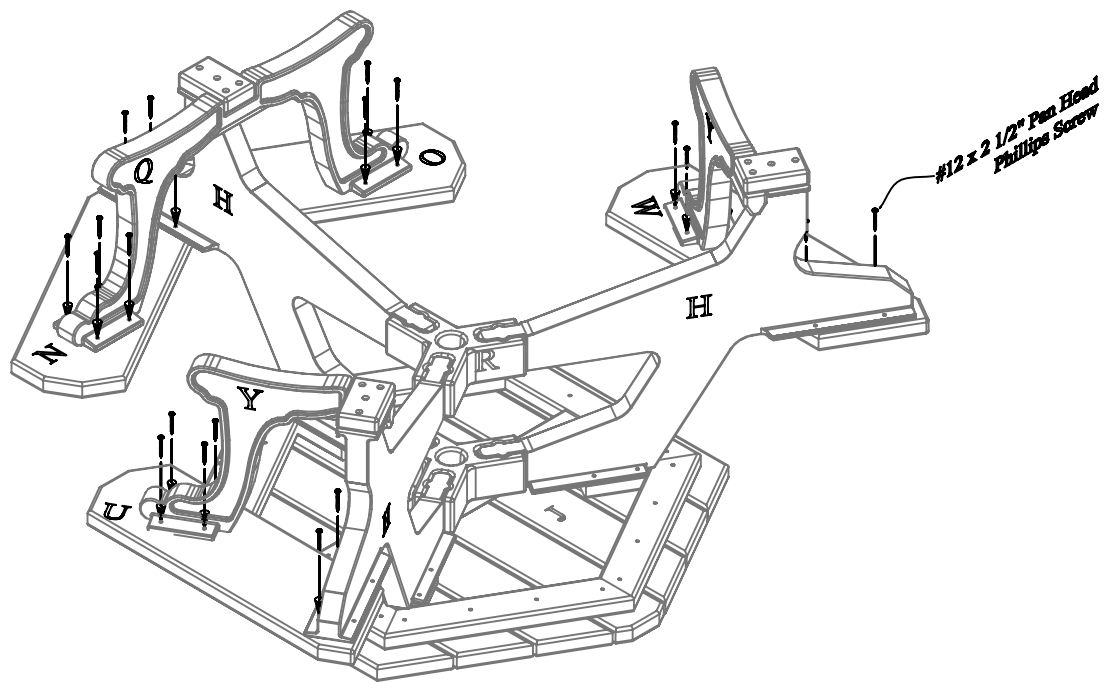

#### Step #5:

While the table is upside down, align the pre-drilled holes in the Seat to the pilot holes in the Seat Support and the Table Leg as shown above. Use ( 1 ) One #12 x 1 1/2" Pan Head Screw per hole to secure.

Be sure to tighten all loose screws after completing this step.



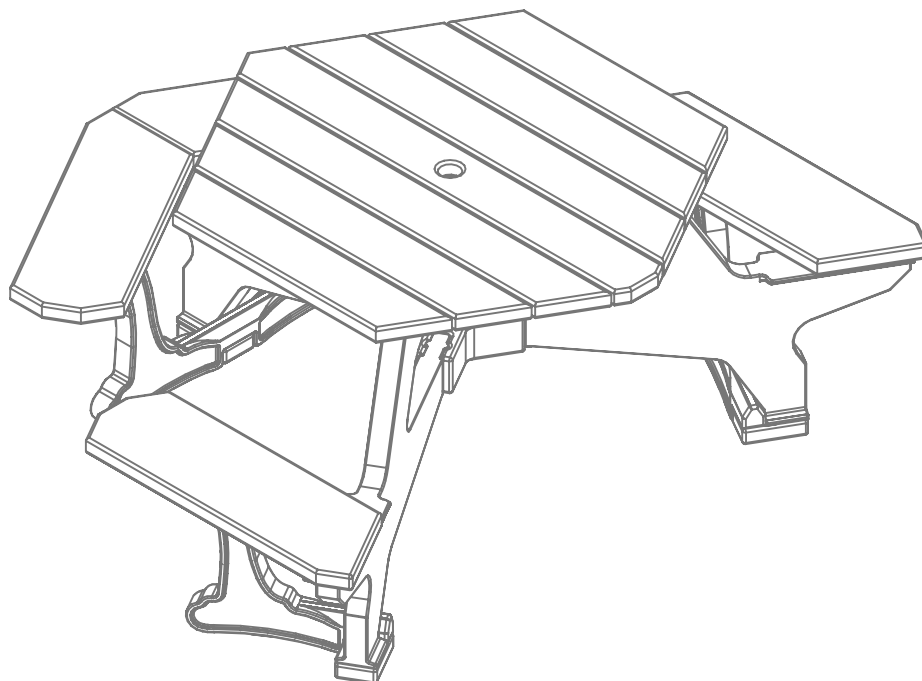

**Step #6:**

With assistance turn the table over on to its legs, please use caution for the table weighs approximately 210 pounds.