

### SPECIFICATIONS

Dimension	Imperial	Metric
Height	45 in.	114 cm.
Width	18 in.	46 cm.
Depth	11 in.	28 cm.
Tank Capacity	16 gal.	61 ltr.
Pump Capacity (per stroke)	2 fl. oz	59.14 ml
Number of Single Dispenses	1024	1024
Weight Empty	16 lb.	7.2 kg.
Weight Full	150 lb.	68 kg.

*All materials, including resin, pigments and additives used to make the plastic components as well as the plumbing components that come in contact with the fresh water are U.S. FDA food grade compliant.*

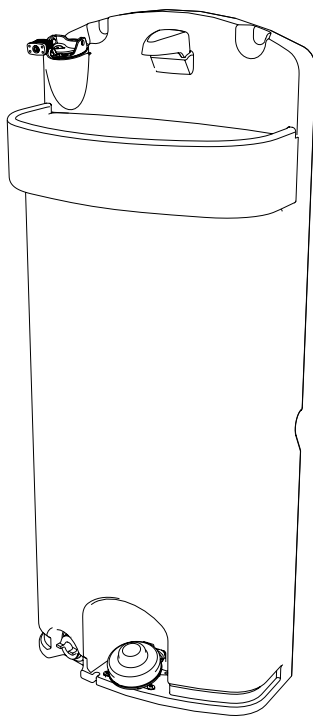

We recommend reading through the entire information booklet prior to proceeding with installation, service and maintenance. All references to left and right throughout the booklet are as viewed from the front of the restroom.

## General Product Information

This self-contained hand wash sink is designed for installation in most portable restrooms. It is supplied fully assembled including all fasteners for installation and will fit on either sidewall. One person will be required for installation with the exception of some assistance to hold the back-up washers when riveting the sink to a sidewall.

## Parts Drawing - Exploded View

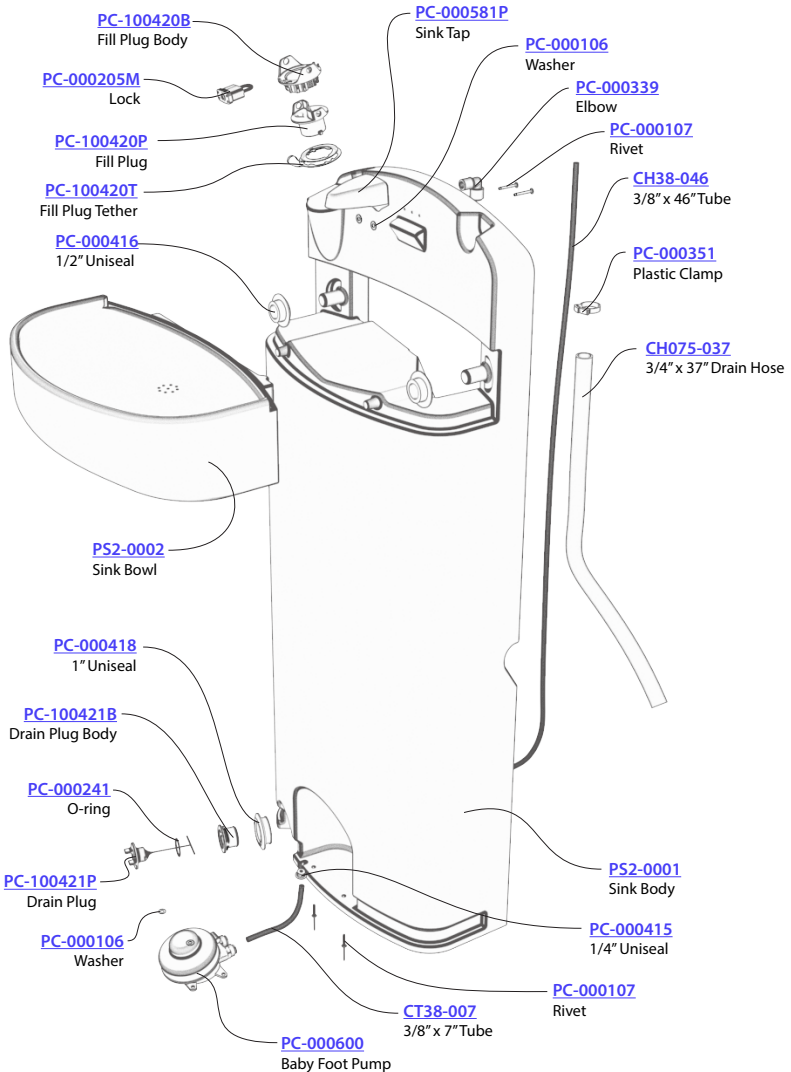

## Full Size Scale Fasteners

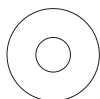

(4) PC-000106 -Washer

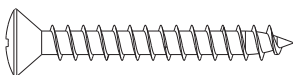

(1) PC-000158 -  
Self-Tapping Screw

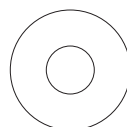

(2) PC-000123 - Washer

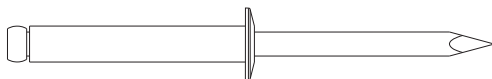

(1) PC-000107 - Rivet

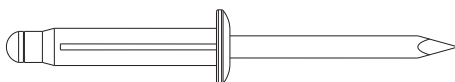

(1) PC-000105 - Rivet

### ~~Tools Required for Installation~~

- *Tape measure*
- *1-1/8" hole saw*
- *Drill with 13/64" bit*
- *Rivet Gun*
- *Phillips, cross-head screwdriver*

### Installation of Sink

**Left Side Installation:** If the unit has a urinal installed, then remove it by drilling out the rivets fastening it to the side panel. Drill a hole for the sink drain in the left side of the tank about 16" up from the floor. The existing urinal hole can be filled with either a PC-000557 (2-1/2" plug) or PC-000560 (1-1/2" plug)(both available at [www.polyjohn.com](http://www.polyjohn.com)). Place the sink flat against the sidewall, making sure the drain hose is routed through the proper molded-in channel along the back and into the hole drilled into the tank. Drill a 13/64" hole through the sink and side panel at the center of the recess to the right of the sink tap. Fasten to the sidewall from the exterior by putting a PC-000106 washer at the head of a PC-000107 rivet and have someone hold a PC-000123 and a PC-000106 washer on the rivet stem on the interior. On the outside of the unit, drill a second 13/64" hole 3" from the vertical rib and approximately 1/2" down from the angled rib as shown to the right. Be sure to drill only through the side panel and into the one wall of the sink. Rivet in place using a PC-000105 rivet with a PC-000106 washer behind the head.

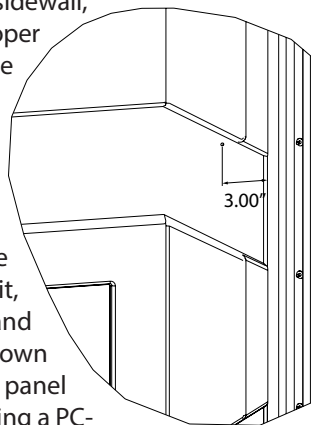

**Right Side Installation:** Drill a hole for the sink drain in the right side of the tank about 16" up from the floor. Place the sink flat against the sidewall, making sure the drain hose is routed through the proper molded-in channel along the back and into the hole drilled into the tank. Drill a 13/64" hole through the sink and side panel at the center of the recess to the left of the sink tap.

## **Installation of Sink Cont.**

Fasten to the sidewall from the exterior by putting a PC-000106 washer at the head of a PC-000107 rivet and have someone hold a PC-000123 and a PC-000106 washer on the rivet stem on the interior. On the outside of the unit, drill a second 13/64" hole 3" from the vertical rib and approximately 1/2" down from the angled rib (see illustration for left side installation for reference). Be sure to drill only through the side panel and into the one wall of the sink. Rivet in place using a PC-000105 rivet with a PC-000106 washer behind the head.

**Attach sink to base skid:** Drive a PC-000158 self-tapping screw in the groove at the bottom of the sink located next to the foot pump.

## **Sink Operation**

**Filling the sink:** Open the blue fill port by pushing down and turning counter-clockwise 1/4 turn. Fill with fresh water. Close fill port.

**Draining the sink:** Turn the drain plug 1/4 turn and pull out. The tether will keep the plug in place. When all the water has been removed, push the plug in and turn 1/4 turn.

## **CLEANING AND MAINTENANCE**

Use a mild soap to clean all surfaces and component parts.

To keep the water fresh add a "Fresh Sink Tablet" (*chlorinated tablet*) each time the sink is filled with water.

### **Winterizing**

- Drain all water from the tank.
- Depress the foot pump to clear lines.
- Flush tank with a solution of chlorine and water.