

Anchoring Surface Mounted Air Kit 3 to Ground

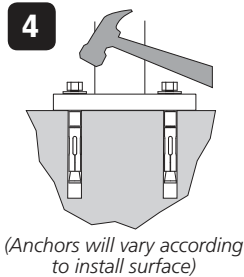
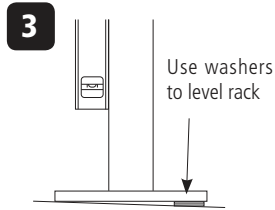
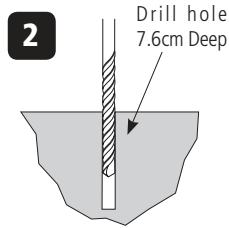
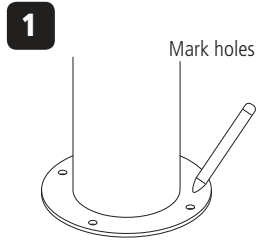

Tools Needed for Installation

- Marker or Pencil
- Masonry Drill Bit 3/8"
- Drill (Hammer drill recommended)
- Hammer
- Wrench 9/16"
- Level

Installation:

3/8" anchors are shipped with the pump. Place the pump in the desired location on the ground. Use a marker or pencil to outline the holes of the flange onto the base material. Drill the holes in accordance with the specifications shipped with the anchors. Make sure the holes are at least 3" away from any cracks in the base material. Use washers to level pump if necessary. Tap in anchors and follow your specific anchor instructions provided with the rack.



Note: All threads for all parts of the pump are right-hand threads. They tighten clockwise, and loosen counter-clockwise ("righty tighty, lefty loosey"). However, when you are looking top-down at a bolt that threads from underneath, if you move it counter-clockwise from your point of view, you are actually tightening, not loosening, the nut! This has led to some unnecessary breakage of pump parts. Be sure you are looking at the nut with the proper orientation before tightening or loosening.

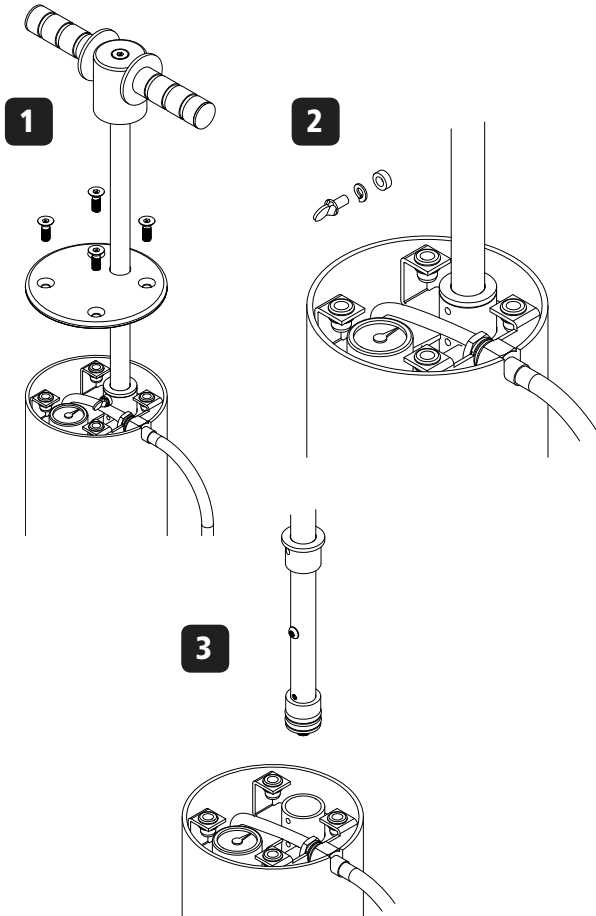

Air Kit 3 Maintenance:

- 1** Remove tamper-resistant screws and lift polycarbonate top and metal gauge plate.
- 2** Remove thumb-screw, lock washer and spacer
- 3** Plunger assembly may now be pulled out. To replace gaskets, pry old gaskets off and clean piston. Apply new silicone grease and install new gaskets. Apply more silicone grease to new gaskets. Re-assemble and wipe off excess grease when done.

Changing the Pumphead

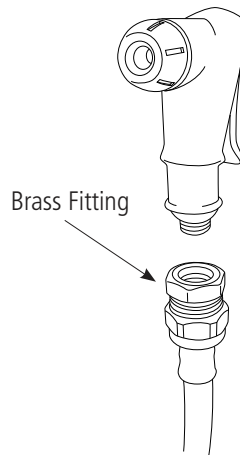

Remove the black heat-shrink covering the base of the pumphead. Unscrew the pumphead from the brass fitting (turning counter-clockwise). You will need to keep the brass fitting for the new pumphead. Replace the pumphead.

If you will be replacing the heat-shrink, then put the heat-shrink sleeve over the hose before replacing pumphead. Once pumphead is on, pull heat-shrink sleeve over the brass fitting and use a heatgun to shrink it.