

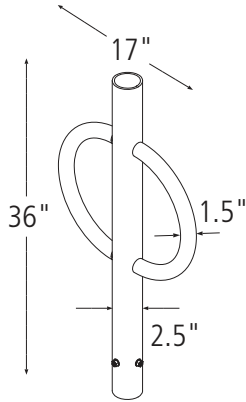

METER HITCH

Specifications and Space Use



Capacity 2 Bikes

Materials Centerbeam: 2.5" schedule 40 pipe



Please specify your post outside diameter and height when ordering

Finishes



An after fabrication hot dipped galvanized finish is our standard option. 250 TGIC powder coat colors, and thermoplastic coating are also available as alternate options.

Our powder coat finish assures a high level of adhesion and durability by following these steps:

1. Sandblast
2. Epoxy primer electrostatically applied
3. Final thick TGIC polyester powder coat

Installation Methods



Meter Hitch slides over existing 2.38" OD parking meter poles. Two tamper-resistant set screws secure the Meter Hitch to the parking meter pole.



To make your intended usage clear to everyone, consider a Meter Hitch with the word "BIKE" welded into the ring.

- 1** Remove meter and slide Meter Hitch over existing pole.

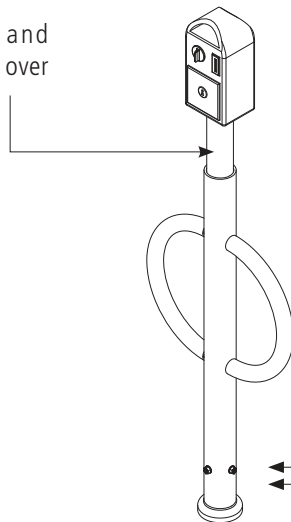

- 2** Use nut as guide to drill shallow 1/4" blind hole in meter pole.

- 3** Secure Meter Hitch with set screws