

**Tools Needed for Installation**

Hammer drill  
 3/8" masonry bit  
 Hammer  
 Socket Wrench  
 9/16" socket  
 Tamper-proof socket (included)  
 Socket extension, 6" min.

- 1** Reference the Fixit setback recommendations and place the upright in the desired location. Use the base as a template and drill (4) 3/8" x 3" holes in the concrete with a hammer drill and masonry bit. Clean up all concrete dust from drilling.

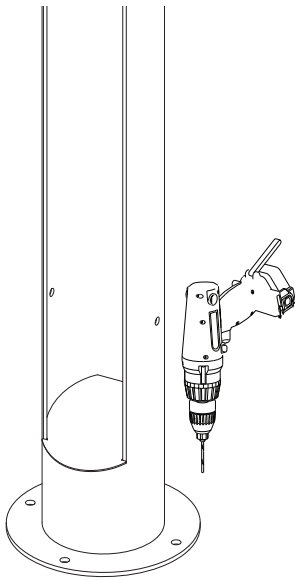

- 2** Hammer in the (4) wedge anchors. Leave at least 3/4" of an inch of exposed threads above the Fixit base.

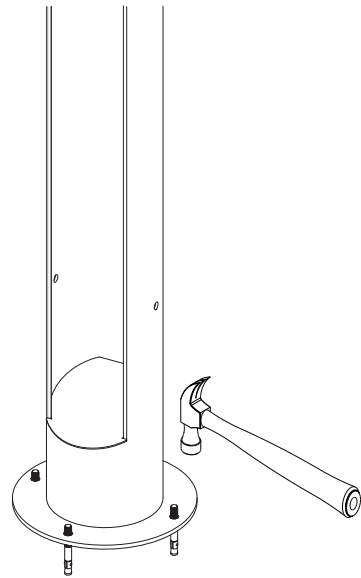

- 3** Decide which position the pump will be installed in and place the bottom pump flange over the corresponding wedge anchor. Attach the top pump flange to the Fixit upright with a carriage bolt, washer, and tamper-proof nut. Tighten all wedge anchors with washers and nuts.

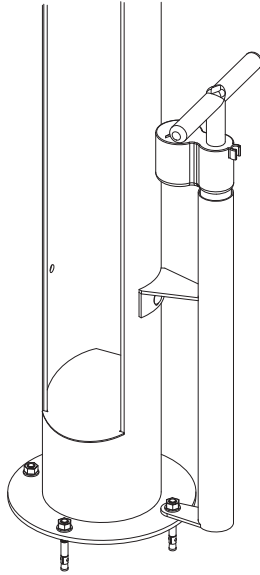

- 4** Insert the tool cables into the cable slot on the Fixit upright.

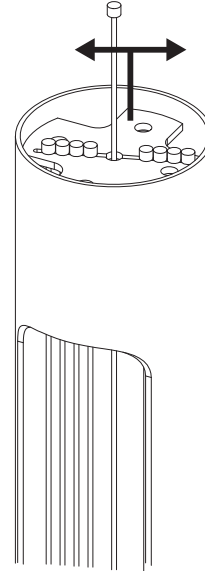

- 5** Place the bike hanger in the desired position on top of the Fixit upright and attach with carriage bolts, washers and nuts.

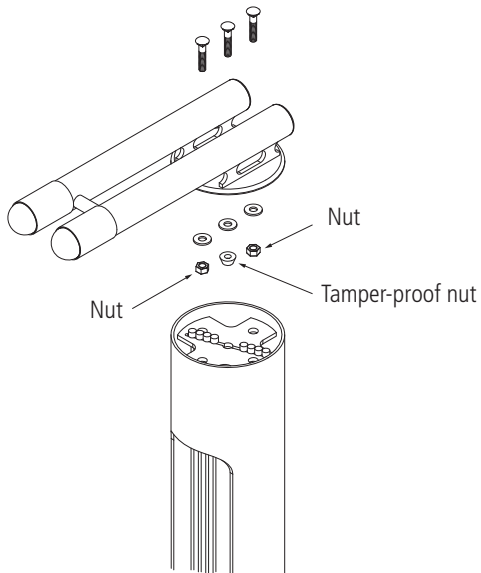

**Note:** All threads for all parts of the pump are right-hand threads. They tighten clockwise, and loosen counter-clockwise ("righty tighty, lefty loosey"). However, when you are looking top-down at a bolt that threads from underneath, if you move it counter-clockwise from your point of view, you are actually tightening, not loosening, the nut! This has led to some unnecessary breakage of pump parts. Be sure you are looking at the nut with the proper orientation before tightening or loosening.

## Removing the Airpump from the Fixit

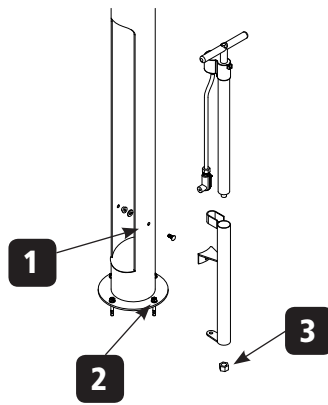

- 1.** Remove nut and bolt on side of Fixit.
- 2.** Remove tamperproof nut on bottom of Fixit, using the Tamperproof Penta Tool supplied for this purpose.
- 3.** Once Airpump is removed, but still in sleeve, remove the 1 3/16" nut on the bottom of the sleeve (turning counter-clockwise). You can now slide the pump out.

## Changing the Pumphead

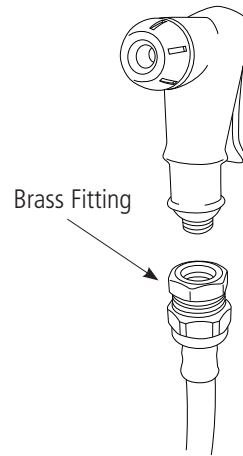

Remove the shrinkwrap. Unscrew the pumphead from the brass fitting (turning counter-clockwise). You will need to keep the brass fitting for the new pumphead. Replace the pumphead. If you want to put on shrinkwrap, then put the shrinkwrap sleeve over the hose before replacing pumphead. Once pumphead is on, pull shrinkwrap sleeve over the brass fitting and use a heatgun to shrink it.

## Lubricating or Removing the Pumphead

Unscrew the cap on the top of the pump that the plunger goes through. This allows you to remove the plunger, and to lubricate or replace the plunger gasket. Use silicone grease only to lubricate the plunger gasket. Doing this every two months will help maintain a proper seal.

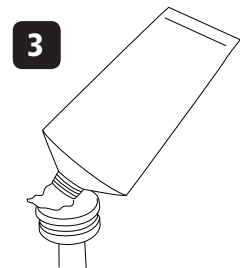
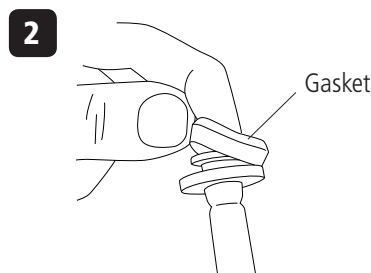
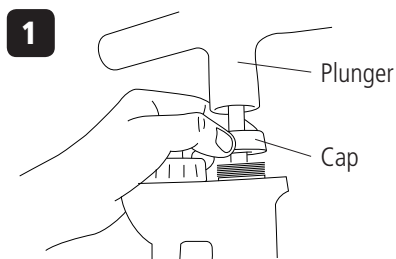

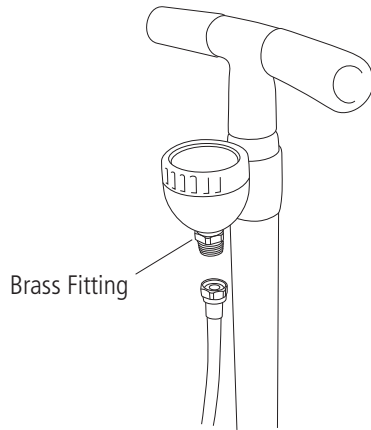

## Replacing the Pump Hose

First, remove the pump from the Fixit (see previous page). Then, remove pump from the metal sleeve. Once the pump is fully removed, you can unscrew the hose, leaving the brass fitting attached to the gauge. You will need two wrenches to loosen the hose—one for the hose, and one for the brass fitting. Be sure to keep the brass fitting, you'll need it to re-attach your new hose.

Attach new hose to the bottom of the brass fitting.

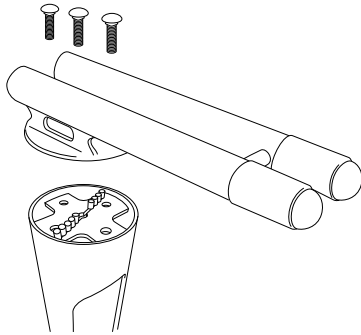

## Replacing Tools

There are three bolts at the top of the Fixit. Underneath are two 3/8" nuts, and one penta tamperproof nut. These are all best removed with a socket wrench, using the extension tool to enable you to reach the nuts. Once the nuts are removed, take off the cap to replace tools.